



Connecting the world  
with smarter energy.



## LITHIUM BATTERIES

WALL MOUNTED | FLOOR MOUNT  
RACK TYPE LITHIUM ENERGY STORAGE SYSTEM



MADE IN INDIA

# Eastman Introduction

Eastman Auto & Power Limited is an Indian manufacturer of solar energy solutions, energy storage systems, and power electronics. Backed by a legacy of innovation and trust built over decades, the company was founded under the visionary leadership of Mr. Jagdish Rai Singal to shape the future of sustainable energy. With a strong global presence, Eastman products are distributed across more than 50 countries spanning Asia, the Middle East, Europe, Africa, the Caribbean, and the Americas.

The company offers a comprehensive portfolio including Lithium Batteries, Inverters, Lead Acid Batteries, and a range of advanced power electronics. Eastman serves diverse energy needs across residential, commercial, and industrial sectors-delivering reliable, efficient, and smart power solutions for a rapidly evolving world.



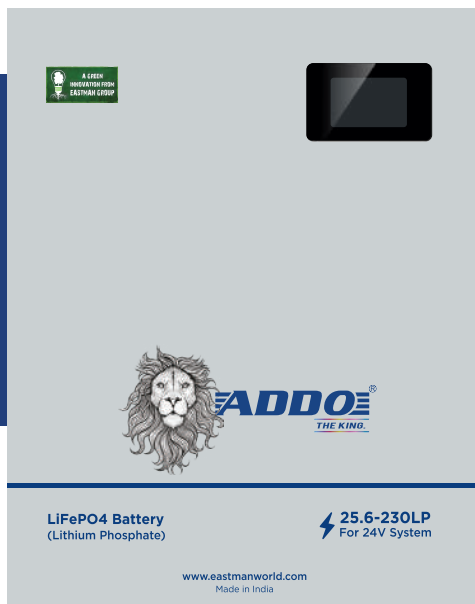

## RESIDENTIAL EA25.6V LiFePO4 (Lithium Phosphate) ENERGY STORAGE BATTERY

**MADE IN INDIA**

### Introduction

Upgrade your Energy Storage with our Lithium Phosphate Battery. Stay informed with real-time operation status via the LCD Screen, ensuring total control and efficiency for your power requirements.

### Connection Diagram

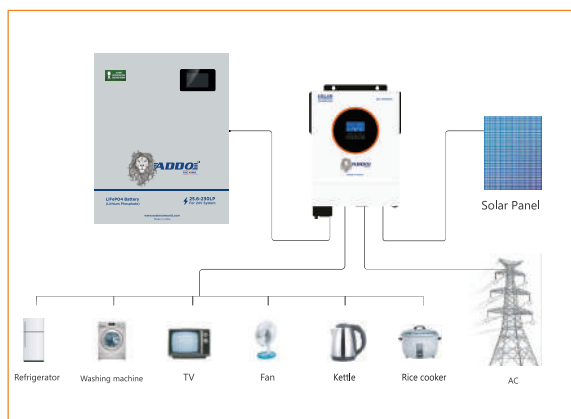

### Product Features

- Real-time monitoring of operation status by LCD Screen.
- Intelligent Air Cooling & Heat dissipation.
- RS485/CAN Communication for connecting more batteries in parallel.
- Installation option: Wall mount.

### Certifications



### Product Specifications

Model	EA25.6-100LP	EA25.6-230LP
Array Mode		8S
Nominal Energy (kWh)	2.5	5.8
Nominal Voltage (V)		25.6
Charge Voltage (V)		29.2
Discharge Cut-off Voltage (V)		21
Standard Charging Current(A)	20	46
Max. Continuous Charging Current (A)		100
Max. Continuous Discharging Current (A)		100
Cycle Life	6000 Cycles @80% DOD @25°C @0.2C/0.2C	
Communication Mode	RS485/CAN, RS232, RS485/RS485	
Parallel Connection	Yes, upto 15 units	
Operating Temp	Charging: 0~60°C; Discharging: -10°C~65°C	
Size(LxWxH) mm	440x170x350	560x470x170
Net Weight (kg)	~23	~45
Gross Weight (kg)	~25	~47
Warranty	5 Years	
Altitude	≤4000m	
Humidity	<90%RH	
Shelf Temperature	10°C~60°C	
Design Life	10+ Years at 25°C/77°F	



## RESIDENTIAL EA51.2V LiFePO4 (Lithium Phosphate) ENERGY STORAGE BATTERY

### Introduction

Upgrade your Energy Storage with our Lithium Phosphate Battery. Stay informed with real-time operation status via the LCD Screen, ensuring total control and efficiency for your power requirements.

**MADE IN INDIA**

### Connection Diagram

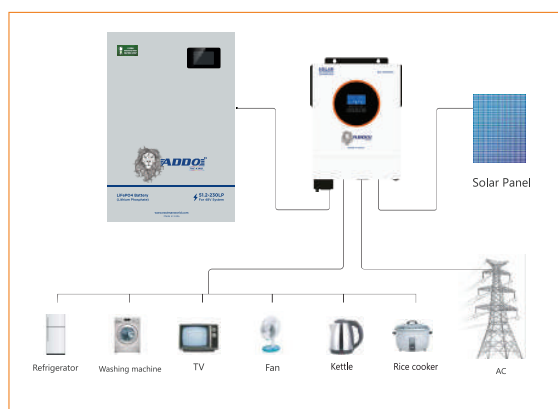

### Product Features

- Real-time monitoring of operation status by LCD Screen.
- Intelligent Air Cooling & Heat dissipation.
- RS485/CAN Communication for connecting more batteries in parallel.
- Installation option: Wall mount.

### Certifications



### Product Specifications

Model	EA51.2-100LP	EA51.2-230LP
Array Mode		16S
Nominal Energy (kWh)	5.1	11.7
Nominal Voltage (V)		51.2
Charge Voltage (V)		58.4
Discharge Cut-off Voltage (V)		42
Standard Charging Current(A)	20	46
Max. Continuous Charging Current (A)	100	200
Max. Continuous Discharging Current (A)	100	200
Cycle Life	6000 Cycles @80% DOD @25°C @0.2C/0.2C	
Communication Mode	RS485/CAN, RS232, RS485/RS485	
Parallel Connection	Yes, upto 15 units	
Operating Temp	Charging: 0~60°C; Discharging: -10°C~65°C	
Size(LxWxH) mm	560x470x170	670x485x244
Net Weight (kg)	~41	~93
Gross Weight (kg)	~43	~106
Warranty	5 Years	
Altitude	≤4000m	
Humidity	<90%RH	
Shelf Temperature	10°C~60°C	
Design Life	10+ Years at 25°C/77°F	

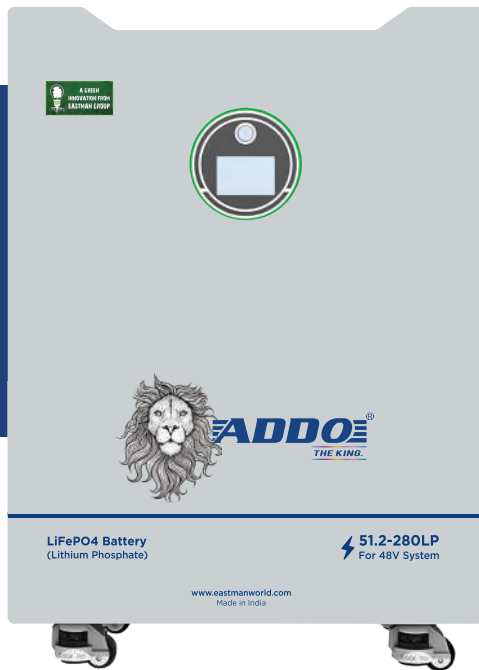

## RESIDENTIAL EA51.2V LiFePO4 (Lithium Phosphate) ENERGY STORAGE BATTERY

**MADE IN INDIA**

### Certifications



### Structural Part Description

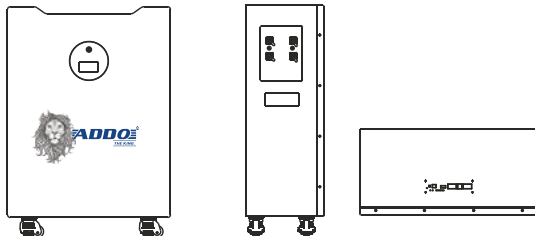

### Introduction

Upgrade your Energy Storage with our Lithium Phosphate Battery. Stay informed with real-time operation status via the LCD Screen, ensuring total control and efficiency for your power requirements.

### Product Features

- LCD Display for monitoring energy storage, power data and operating status.
- High-Quality LiFePo4 Battery for Deep Cycle and Long Lifespan.
- Metal Casing that ensures waterproof and explosion-proof safety.
- External Main Switch to reduce product power consumption and improve safety.
- Mobile bottom wheels designed for easy installation across various locations with ease.
- In-built BMS for Over-Voltage, Over-Load and Over-Temperature protection.
- Compatible - It can be connected to different types of loads within the voltage range.
- Installation option: Floor mount.

### Product Specifications

Model	EA51.2-280LP
Array Mode	16S
Nominal Energy (kWh)	14.3
Nominal Voltage (V)	51.2
Charge Voltage (V)	58.4
Discharge Cut-off Voltage (V)	42
Standard Charging Current(A)	56
Max. Continuous Charging Current (A)	200
Max. Continuous Discharging Current (A)	200
Cycle Life	6000 Cycles @80% DOD @25°C @0.5C/0.5C
Communication Mode	RS485/CAN, RS232, RS485/RS485
Parallel Connection	Yes, upto 15 units
Operating Temp	Charging: 0~60°C; Discharging: -10°C~65°C
Size(LxWxH) mm	750x580x279
Net Weight (kg)	~113
Gross Weight (kg)	~128
Warranty	5 Years
Altitude	≤4000m
Humidity	<90%RH
Shelf Temperature	10°C~60°C
Design Life	10+ Years at 25°C/77°F



# RACK TYPE LITHIUM ENERGY STORAGE BATTERY

**MADE IN INDIA**

## Connection Diagram

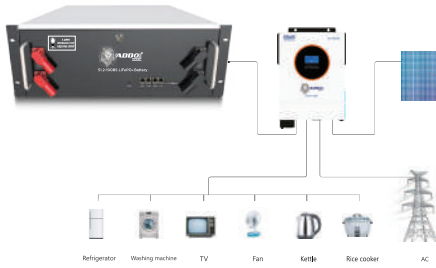

## Certifications



## Applications

- Telecom
- UPS
- Emergency Light
- Solar System
- Wind Power

## Introduction

Optimize your Energy Solution with our Rack-Type Energy Storage. Featuring advanced warning functions for secure and dependable operation in all conditions.

## Product Features

- Standardized Design: Our 3U and 4U Standardized case ensures broad applicability.
- Enhanced Energy Capacity: Support multiple parallel battery usage to meet high energy demands.
- Intelligent Lithium Battery Management System: Equipped with RS485 communication, offers real-time battery monitoring and customizable protection parameters such as charge & discharge.
- Balancing: Automatic collection of battery single series voltage, pressure difference up to 30 Mega Volt (can be set) with an automatic start equalization function.
- Warning Function: Advanced warning functions, including Overcharge, Over-Discharge, Over-Current, High-Temperature and Low-Temperature alerts reducing potential safety risks.

## Product Specifications

Model	EA51.2-100BS	EA51.2-400BS
Array Mode	16S	16S x4 (Module)
Nominal Energy (kWh)	5.1	20.0
Nominal Voltage (V)		51.2
Charge Voltage (V)		58.4
Discharge Cut-off Voltage (V)		42
Standard Charging Current(A)	20	20x4
Max. Continuous Charging Current (A)	100	100x4
Max. Continuous Discharging Current (A)	100	100x4
Cycle Life	6000 Cycle @80% DOD @25°C @0.2C/0.2C	
Communication Mode	RS485/CAN	
Operating Temp	Charging: 0~60°C; Discharging: -10°C~65°C	
Size(LxWxH) mm	520x495x175	600x600x1000 (with cabinet)
Net Weight (kg)	~44	~200
Gross Weight (kg)	~46	~210
Warranty	5 Years	
Altitude	≤4000m	
Humidity	<90%RH	
Shelf Temperature	10°C~60°C	
Design Life	10+ Years at 25°C/77°F	



# RACK TYPE LITHIUM ENERGY STORAGE SYSTEM

Sr. No.	Item Description	Referance Image	QTY.	UOM
1	Rack 4P with Four Wheels and one AC Extension Board		1	Nos.
2	Battery Pack		4	Nos.
3	Connection Cable Negative Terminal		3	Nos.
4	Connection Cable Positive Terminal		3	Nos.
5	Rack To Inverter Connection Cable Negative Terminal		1	Nos.
6	Rack To Inverter Connection Cable Positive Terminal		1	Nos.
7	Ph Head M6*12		16	Nos.



[www.eastmanworld.com](http://www.eastmanworld.com)  
[marketing@eastmanworld.com](mailto:marketing@eastmanworld.com)

**AMPS MIDDLE EAST FZ LLC**

#703, 7<sup>th</sup> Floor, Deira Twin Tower,  
Baniyas Square, Deira, Dubai (UAE)

**EASTMAN AUTO & POWER LTD.**

Quattro Towers, 249, Udyog Vihar Phase-4, Gurugram,  
Haryana 122016, India

**EASTMAN NEW ENERGY PRIVATE LIMITED**

Plot No 264, Sector-7, IMT Manesar, District - Gurugram  
Haryana-122050, India

Follow us on »  @eastman\_world  @EastmanWorld  @EastmanWorld